

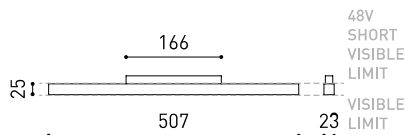

## DIMENSIONS



## ACCESSOIRES



TRACK 48V OPTIONS

## PRODUIT

Nom	LINE 500 48V 4000K N
Référence	A3761012N
Coleur	Noir Mat
RAL	Anodisé, bain coloré, similaire à RAL 9005
Catégorie	TRACKLIGHTS

## SOURCE DE LUMIÈRE

Type	LED
Flux lumineux brut	1650 lm
Température de couleur	4000 K
Stabilité chromatique	MacAdam Step 2
Indice de reproduction chromatique	CRI > 90
Puissance	10,5 W
Courant	350 mA
Efficacité	157 lm/W
Durée de vie de la LED	L80B10 > 60.000h

## LUMINAIRE | DONNÉES PHOTOMÉTRIQUES

Efficacité lumineuse	43%
Angle du faisceau lumineux	98°

## LUMINAIRE | DONNÉES ÉLECTRIQUES

Driver	Inclus
Valeurs de puissance du système	11,05 W
Tension	48Vdc
Variation d'intensité	Non Dim
Classe d'isolation électrique	II

## D'AUTRES DONNÉES

Étanchéité	IP20
Contrôle sans fil	Veillez consulter
Type de rail	Track 48V
Poids	230 g
Poids avec emballage	400 g
Dimensions de l'emballage	Ø55 x 550 mm
Unités par emballage	1
Matériaux	Aluminium / Polycarbonate

Line 48V est le luminaire à lumière diffuse linéaire pour application sur rail à basse tension de 48V. Cette solution transfère à ce système de rails les caractéristiques d'éclairage et les avantages de l'éclairage longitudinal avec un diffuseur pour les applications d'éclairage général.

DIAGRAMME POLAIRE



DIAGRAMME CONIQUE



UGR

Glare Evaluation According to UGR												
		70	70	50	50	30	70	70	50	50	30	30
p Ceiling		50	30	50	30	30	50	30	50	30	30	30
p Walls		20	20	20	20	20	20	20	20	20	20	20
p Floor		20	20	20	20	20	20	20	20	20	20	20
Room Size X Y		Viewing direction at right angles to lamp axis					Viewing direction parallel to lamp axis					
2H	2H	22.4	23.7	22.7	23.9	24.1	22.8	24.1	23.1	24.3	24.5	
	3H	24.1	25.3	24.5	25.6	25.8	24.5	25.7	24.8	25.9	26.2	
	4H	24.9	26.0	25.2	26.3	26.6	25.1	26.2	25.4	26.5	26.8	
	6H	25.5	26.5	25.9	26.8	27.2	25.5	26.6	25.9	26.9	27.2	
	8H	25.8	26.8	26.1	27.1	27.4	25.7	26.7	26.0	27.0	27.3	
4H	12H	26.0	27.0	26.4	27.3	27.7	25.7	26.7	26.1	27.0	27.4	
	2H	23.0	24.1	23.3	24.4	24.7	23.3	24.4	23.6	24.7	25.0	
	3H	25.0	25.9	25.4	26.3	26.6	25.2	26.2	25.6	26.5	26.9	
	4H	25.9	26.7	26.3	27.1	27.4	26.0	26.9	26.4	27.2	27.6	
	6H	26.7	27.4	27.1	27.8	28.2	26.6	27.3	27.0	27.7	28.1	
8H	12H	27.0	27.7	27.4	28.1	28.5	26.8	27.5	27.2	27.9	28.3	
	2H	27.4	28.0	27.8	28.4	28.8	26.9	27.5	27.4	28.0	28.4	
	3H	26.2	26.9	26.7	27.3	27.7	26.4	27.0	26.8	27.4	27.8	
	4H	27.2	27.7	27.6	28.2	28.6	27.1	27.7	27.6	28.1	28.5	
	6H	27.7	28.1	28.1	28.6	29.1	27.4	27.9	27.9	28.3	28.8	
12H	12H	28.1	28.5	28.6	29.0	29.5	27.6	28.0	28.1	28.5	29.0	
	4H	26.3	26.9	26.7	27.3	27.7	26.4	27.0	26.8	27.4	27.9	
	6H	27.3	27.8	27.8	28.2	28.7	27.2	27.7	27.7	28.1	28.6	
	8H	27.8	28.2	28.3	28.7	29.2	27.5	28.0	28.0	28.4	28.9	
Variation of the observer position for the luminaires distances S												
S = 1.0H		+0.1 / -0.1					+0.1 / -0.1					
S = 1.5H		+0.2 / -0.3					+0.2 / -0.3					
S = 2.0H		+0.3 / -0.7					+0.4 / -0.7					
Standard table		BK07					BK06					
Correction Summand		6.1					5.7					
Corrected Glare Indices referring to 1650lm Total Luminous Flux												

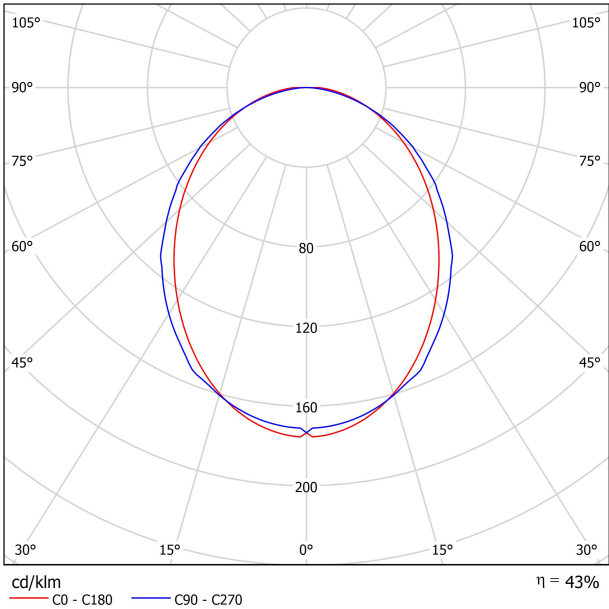
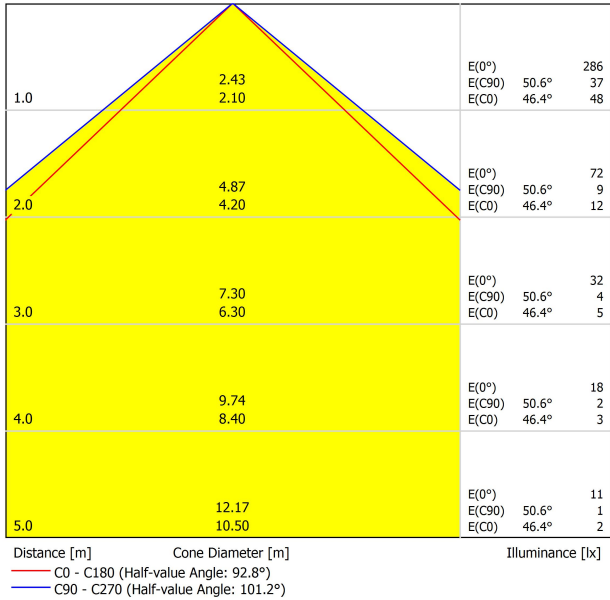
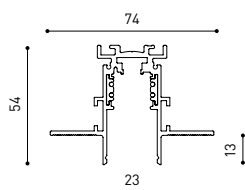
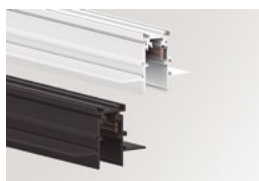

## TRACK 48V TRIMLESS

TRACK 48V TRIMLESS 1m	A338-01-00-   N   WT
TRACK 48V TRIMLESS 2m	A338-02-00-   N   WT
TRACK 48V TRIMLESS 3m	A338-03-00-   N   WT
TRACK 48V TRIMLESS Corner 90° One Plane	A338-06-00-   N   WT
TRACK 48V TRIMLESS Corner 90° Two Planes	A338-07-00-   N   WT

PLASTERBOARD CEILING, MANDATORY THICKNESS 12,5mm.  
RECOMMENDED FOR INSTALLATIONS WHERE THE PROFILE CAN BE  
INSTALLED BEFORE THE FALSE PLASTERBOARD CEILING.



TRIMLESS INSTALLATION GUIDE  
<https://youtu.be/tgGsQdaYe-w>

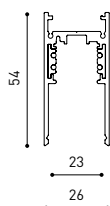

## TRACK 48V SURFACE

TRACK 48V SURFACE 1m	A338-11-00-   NT   WT
TRACK 48V SURFACE 2m	A338-12-00-   NT   WT
TRACK 48V SURFACE 3m	A338-13-00-   NT   WT
TRACK 48V SURFACE Corner 90° One Plane	A338-14-00-   NT   WT

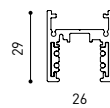

## TRACK 48V SURFACE SHORT

TRACK 48V SURFACE SHORT 1m	A338-21-00-   NT   WT
TRACK 48V SURFACE SHORT 2m	A338-22-00-   NT   WT
TRACK 48V SURFACE SHORT 3m	A338-23-00-   NT   WT
TRACK 48V SURFACE SHORT Corner 90° One Plane	A338-24-00-   NT   WT



## TRACK 48V TRIMLESS Corner 90° One Plane

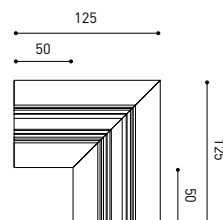

\*Electrical connection not included

## TRACK 48V TRIMLESS Corner 90° Two Planes

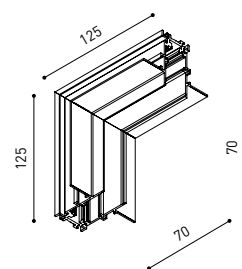

\*Electrical connection not included

## TRACK 48V SURFACE Corner 90° One Plane

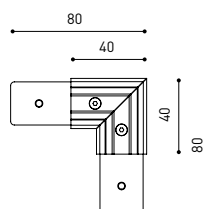

Electrical connection not included  
Straight joiner included

## TRACK 48V SURFACE SHORT Corner 90° One Plane

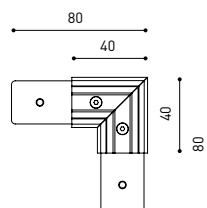

Electrical connection not included  
Straight joiner included

COLOUR | N ■ RAL 9005 | NT ■ RAL 9005 | WT □ RAL 9016 |

# TRACK 48V

ARKOSLIGHT

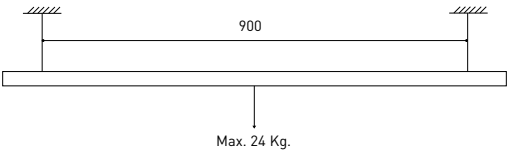

DROP VOLTAGE TABLE

		CABLE LENGTH (m)			
		5	10	20	30
POWER (W)	CABLE SECTION (mm²)	TRACK LENGTH (m)			
		50	50	X	X
100	0,75	50	50	X	X
	1,5	50	50	40	25
150	0,75	40	15	X	X
	1,5	50	40	20	X

		P	V	D
CONSTANT VOLTAGE LED POWER SUPPLY	0434-01-61*   N I	100W	48V	298 x 16 x 19 mm
	0434-01-62	150W	48V	350 x 30 x 18 mm

220 V ~  
240

\*To be installed inside the track.

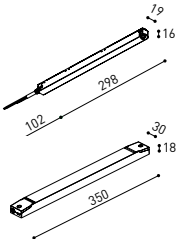

## COMPATIBILITY ACCORDING TO TYPE OF TRACK

### TRACK 48V & TRACK 48V SURFACE SHORT

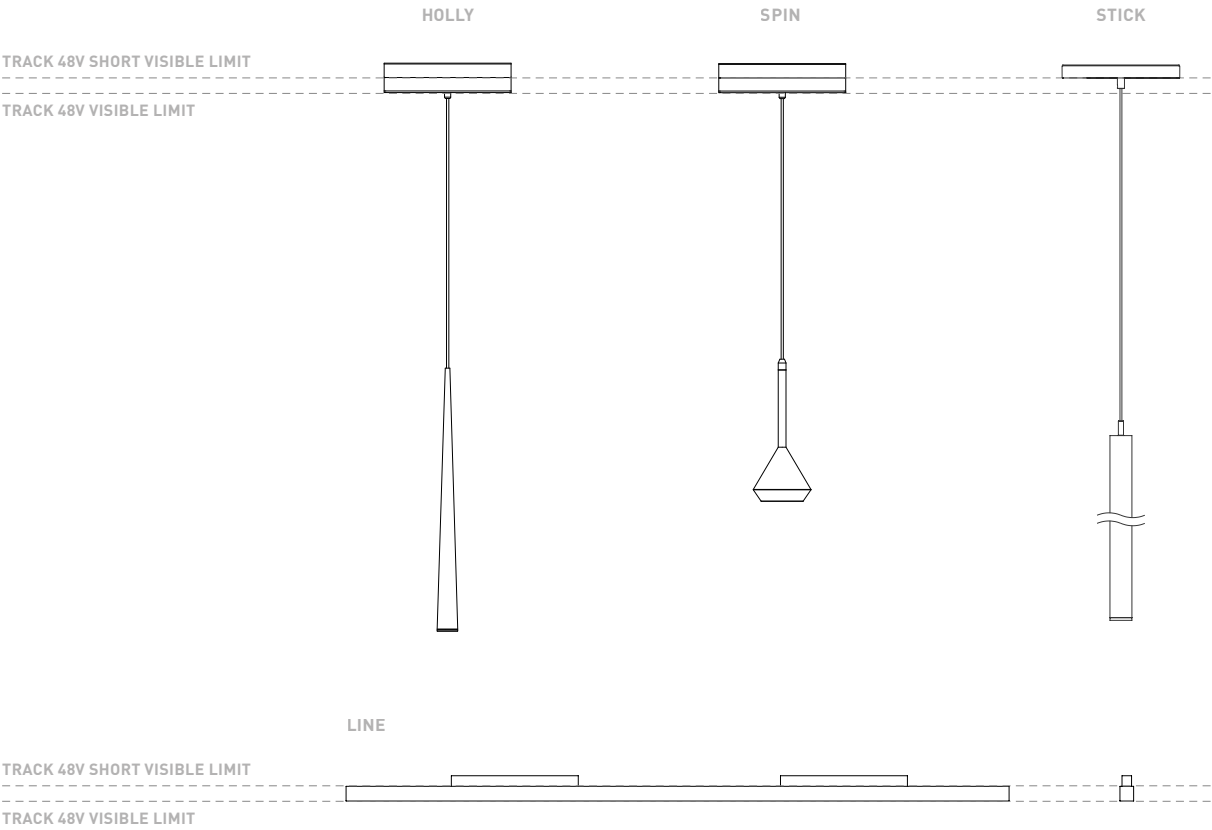

COLOUR | N ■ RAL 9005 |



## ALL 48V TRACK

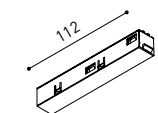

**Live-End Connector 48V**

A338-00-01- | W | N |

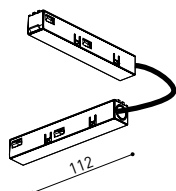

**L-JOINT Connector 48V**

A338-00-12- | W | N |

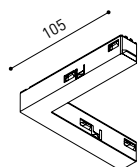

**Corner 90° Connector One Plane 48V**

A338-00-24- | W | N |

\*Not suitable for trimless version

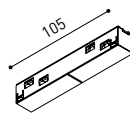

**Central Connector 48V**

A338-00-02- | W | N |

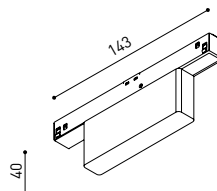

**Wireless Control 48V**

0434-01-31- | W | N | Casambi/AAG Stucchi App

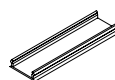

**Cover Gap 1m 48V**

A338-00-30- | N | W |

## TRIMLESS 48V



**Trimless T-Bracket 48V**

A338-00-03



**Trimless Clamp for M6 ROD 48V**

A338-00-09

\*See accessories quantities

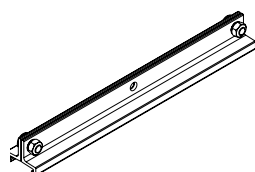

**Trimless Long T-Bracket 48V**

A338-00-04



**Trimless Track Clamp 48V**

A338-00-10

\*See accessories quantities

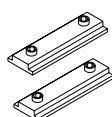

**Trimless Straight Joiner 48V (2 Units)**

A338-00-05- | WT | N |



**Trimless Suspension Kit 48V**

A338-00-08

\*See accessories quantities

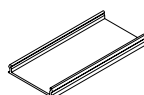

**Trimless Plaster Installation Guard 1m 48V**

A338-00-21

### \* SUGGESTED MOUNTING ACCESSORIES QUANTITIES

1000mm - 2 Pcs.

2000mm - 3 Pcs.

3000mm - 4 Pcs.

## SURFACE, SUSPENSION , SURFACE SHORT & SUSPENSION SHORT 48V

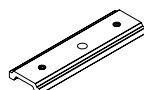

**Surface Straight Joiner 48V**

A338-00-11

COLOUR | N ■ RAL 9005 | W □ RAL 9016 | NT ■ RAL 9005 | WT □ RAL 9016 |

## TRIMLESS, SURFACE & SUSPENSION 48V



### End 48V

A338-00-06- | WT | NT |



### End feed 48V

A338-00-07- | WT | NT |



### Short End 48V

A338-00-18- | WT | NT |



### Short End feed 48V

A338-00-19- | WT | NT |

## SURFACE & SURFACE SHORT 48V

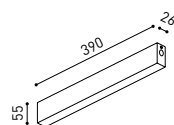

### Power Supply Case 48V

A338-00-29- | NT | WT | 150 W

220 V ~ 240 V ~ INCL To be installed aside 48V Surface Tracks

## SUSPENSION & SUSPENSION SHORT 48V

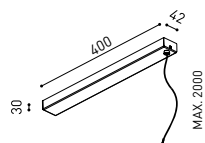

### Wired Power Supply Case 48V

A338-00-25- | NT | WT | 150 W NO DIM

A338-00-26- | NT | WT | 150 W DIM

220 V ~ 240 V ~ INCL

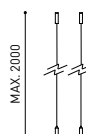

### Suspension Kit 48V [2 units]

A338-00-15- | WT | NT |

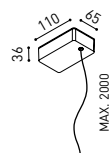

### Suspension Feed Kit 48V

A338-00-16- | W | N | NO DIM

A338-00-17- | W | N | DIM

For remote power supply

A338-00-27- | W | N | NO DIM

A338-00-28- | W | N | DIM

For power supply inside the track

## WIRE TRIMLESS ACCESSORIES

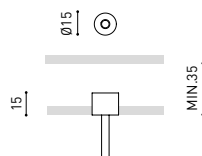

### FEED

#### MAINS TRIMLESS\*

A023-00-01- | W | N | NO DIM

#### MAINS THICK TRIMLESS\*

A023-00-02- | W | N | DIM

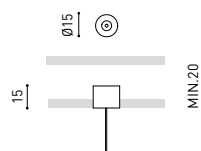

### FASTENING

#### STEEL CABLE TRIMLESS\*

A023-00-05- | W | N |



MAINS TRIMLESS

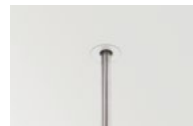

MAINS THICK TRIMLESS

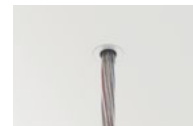

STEEL CABLE TRIMLESS

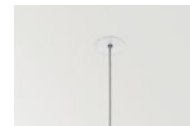

COLOUR | N ■ RAL 9005 | W □ RAL 9016 | NT ■ RAL 9005 | WT □ RAL 9016 |

\* AS MANY PIECES AS NEEDED ACCORDING TO YOUR PRODUCT

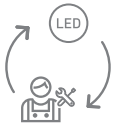

Fuente de luz (LED) reemplazable por un profesional autorizado

Replaceable (LED only) light source by an authorized professional.

Source lumineuse (LED) remplaçable par un professionnel agréé

Sorgente luminosa (LED) sostituibile da parte di un professionista autorizzato

Austauschbare (LED) Lichtquelle durch einen autorisierten Fachmann



Equipo de control reemplazable por un profesional autorizado

Replaceable control gear by an authorized professional

Dispositif de commande remplaçable par un professionnel agréé

Alimentatore sostituibile da parte di un professionista autorizzato

Auswechselbares Betriebsgerät durch autorisierten Fachmann

INSTRUCCIONES PARA EL FINAL DE VIDA Y LA ELIMINACIÓN LOS COMPONENTES  
INSTRUCTIONS ON END-OF-LIFE AND COMPONENT DISPOSAL  
INSTRUCTIONS POUR LA GESTION DES COMPOSANTS EN FIN DE VIE ET LEUR MISE AU REBUT  
ISTRUZIONI PER IL FINE VITA E LO SMALTIMENTO DEI COMPONENTI  
ANWEISUNGEN ZUR ENTSORGUNG DER LEUCHTENKOMPONENTEN



Interrumpir la alimentación del aparato  
Cut the power supply to the luminaire  
Couper l'alimentation du luminaire  
Interrompere l'alimentazione dell'apparecchio  
Stromversorgung der Leuchte unterbrechen

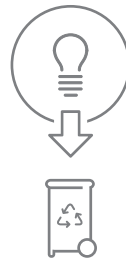

Quitar la(s) fuente(s) de luz para el desecho  
Remove light source(s) for disposal  
Retirer la (les) source(s) lumineuse(s) pour l'élimination  
Rimuovere la/le sorgente/e di luce per lo smaltimento  
Lichtquelle(n) zur Entsorgung entfernen

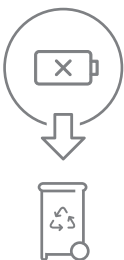

Quitar la batería para el desecho  
Remove the battery for decommissioning  
Retirer la batterie pour sa mise au rebut  
Rimuovere la batteria per la dismissione  
Die Batterie ordnungsgemäß entsorgen



Quitar el equipo de control para el desecho  
Remove control gear for disposal  
Retirer le dispositif de commande pour l'élimination  
Rimuovere l'alimentatore per lo smaltimento  
Betriebsgerät zur Entsorgung ausbauen

Enviar los materiales a un centro de recogida RAEE  
Send the materials to a WEEE collection centre  
Envoyer les matériaux dans une déchetterie DEEE  
Inviare i materiali ad un centro di raccolta RAEE  
Die Materialien in einem WEEE-Zentrum entsorgen

